

ORDINANCE NO. _____

AN ORDINANCE APPROVING REZONE #17-03; WALNUT AVE. RESIDENTIAL TO INDUSTRIAL CONVERSION AMENDING THE ZONING MAP OF THE COUNTY OF TEHAMA THAT WILL MAINTAIN CONSISTENCY WITH THE 2009-2029 TEHAMA COUNTY GENERAL PLAN

THE BOARD OF SUPERVISORS OF THE COUNTY OF TEHAMA ORDAINS AS FOLLOWS:

SECTION 1: The Zoning Map of the County of Tehama, as set forth in Section 17.06.020 of the Tehama County Code and its subsections, is hereby amended by the addition of a new subsection 17.06.020.17-03, being Amended Zoning Map No. 17-03.

SECTION 2: Amended Zoning Map No. 17-03 is comprised of Exhibit 1 attached hereto and incorporated herein. The brief description of the properties, as recited in the notice of hearing is as follows:

Assessor's Parcel Number:024-170-042; The Project consists of one parcel that is located on the north side of Walnut Ave. approximately 1,800 feet west of Baker Road and further described as portions of Sections 25, Township 27N, Range 4W, M.D.B.&M.

SECTION 3: This ordinance shall take effect thirty (30) days from the date of its adoption, and prior to the expiration of fifteen (15) days from the adoption thereof shall be published at least one time in the *Red Bluff Daily News*, a newspaper of general circulation in Tehama County.

The foregoing ordinance was duly passed and adopted by the Board of Supervisors of the County of Tehama, State of California, at a regular meeting of the Board of Supervisors on the _____ day of _____, 2017 by the following vote:

AYES:

NOES:

ABSENT OR NOT VOTING:

CHAIRMAN, Board of Supervisors

STATE OF CALIFORNIA)
) ss
COUNTY OF TEHAMA)

I, Jennifer A. Vise, County Clerk and ex-officio Clerk of the Board of Supervisors of the County of Tehama, State of California, hereby certify the above and foregoing to be a full, true and correct copy of an ordinance adopted by said Board of Supervisors on the _____ day of _____, 2017.

DATED: This _____ day of _____, 2017.

Jennifer A. Vise, County Clerk and ex-officio Clerk of the Board of Supervisors of the County of Tehama, State of California.

By _____
Deputy

EXHIBIT 1

ZONING MAP OF THE COUNTY OF TEHAMA

Rezone #17-03; Walnut Ave. Industrial Conversion
 Zoning Map Pursuant to Section 17.060.020
 of the Tehama County Code
 PTN. Sec. 25 of T27N, R4W, M.D.B.&M.

Zoning Ordinance Map

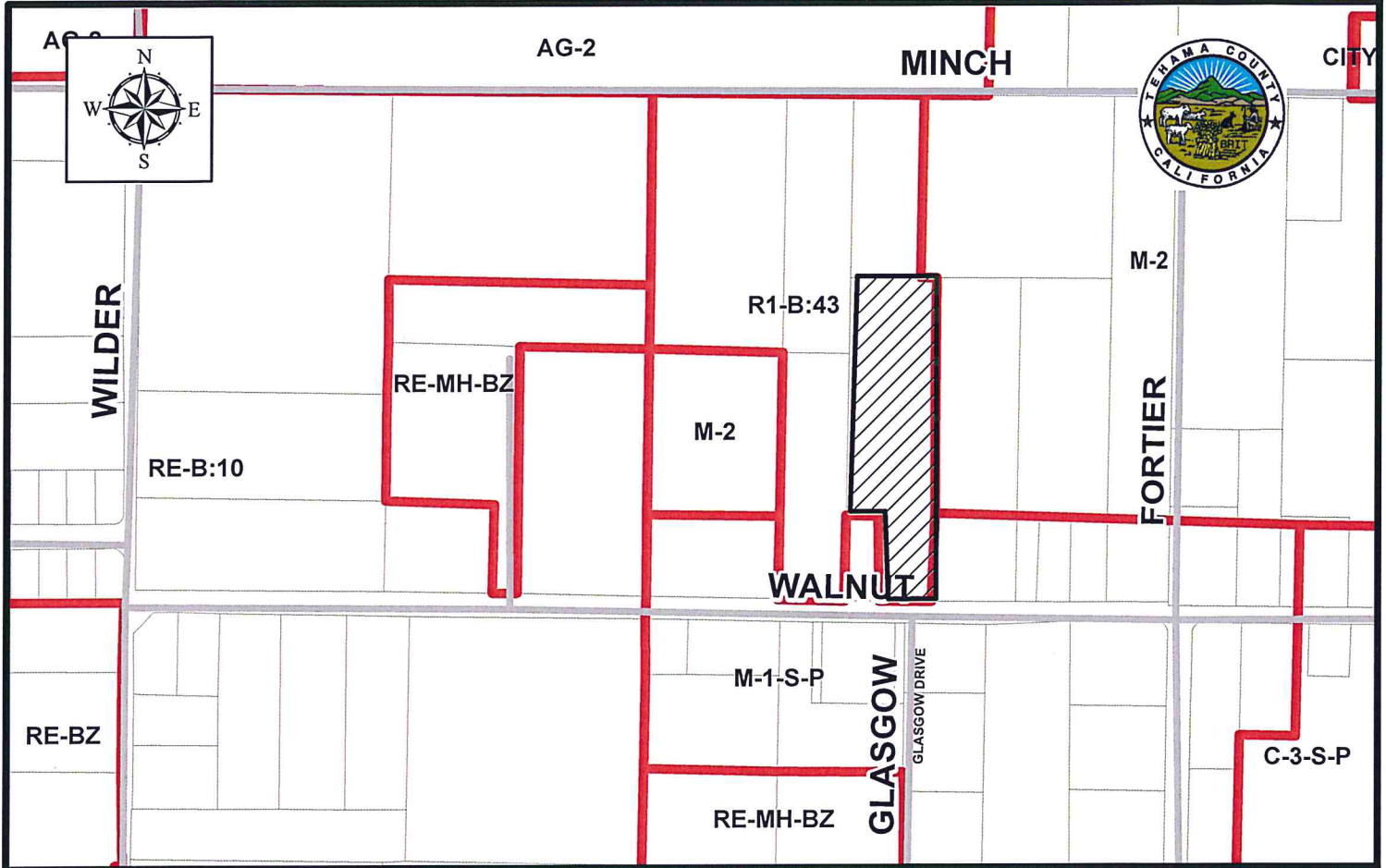

R1-A-B:86

Rezone R1-B:43; One-Family Residence
 ; Special Building Site Combining
 (43,000 sq. ft., 1 acre minimum) Zoning District
 to proposed M-2; General Industrial
 Zoning District.

0 235 470 940 Feet

ACTION BY THE TEHAMA COUNTY
 PLANNING COMMISSION,
 KRISTEN MAZE

ORDINANCE # _____
 ADOPTED:
 BY THE TEHAMA COUNTY
 BOARD OF SUPERVISORS
 JENNIFER A. VISE

SECRETARY _____

DATE _____

CLERK _____
 DEPUTY _____